

NEW

Sunnata touch dimmer & switch

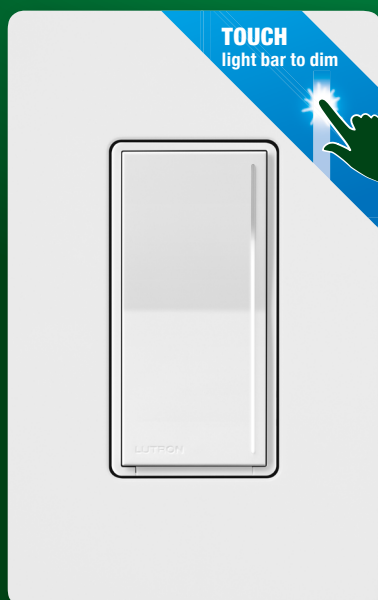

LED+ dimmer

STCL-153M-XX (New Model Number)

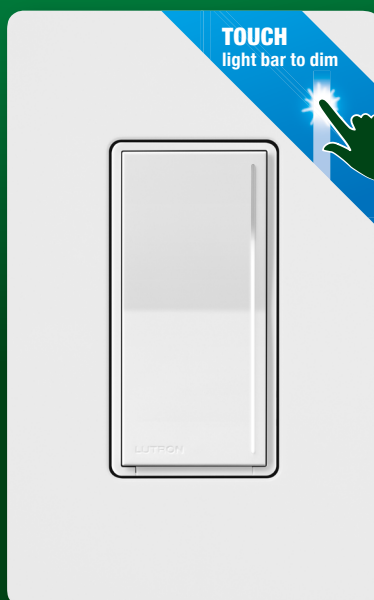

PRO LED+ dimmer

ST-PRO-N-XX

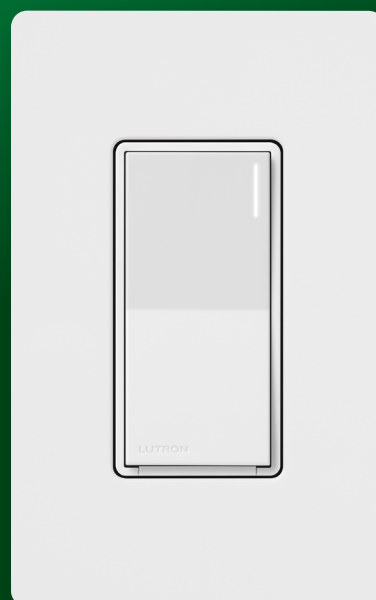

Switch

ST-6ANS-XX

Next generation design and technology

- Touch or swipe the light bar to set your lights
- Soft glow helps you find in the dark
- Lights gradually fade on and off
- Matching look and feel in multiple locations
- MyLevel personalization gives you the ability to customize your Sunnata touch dimmer
- **PRO LED+ advanced technology** for superior dimming of LED, halogen, incandescent, MLV and ELV lighting (PRO LED+ dimmer)
- RTISS™ Technology reduces flickering lights



For more information: lutron.com/SunnataForPro
Order now: Contact your local electrical distributor

Sunnata LED+ Controls

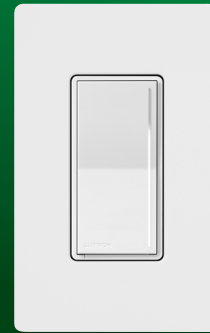

Sunnata LED+ Dimmer
STCL-153M-XX
List Price:
\$53.00 USD
\$66.50 CAN

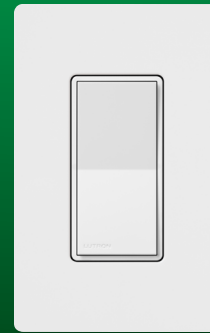

Sunnata Accessory Switch
ST-AS-XX
List Price:
\$23.80 USD
\$29.95 CAN

Load ratings



Available in 4 gloss colors



Sunnata PRO LED+ Controls

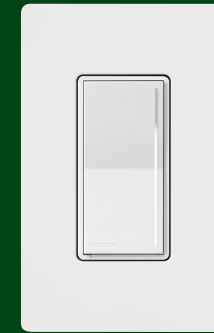

Sunnata PRO LED+ Dimmer
ST-PRO-N-XX
List Price:
\$139.90 USD
\$176.00 CAN

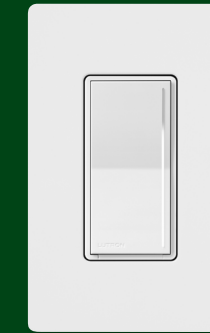

Sunnata PRO Companion Dimmer
ST-RD-XX
List Price:
\$99.00 USD
\$125.00 CAN

Load ratings

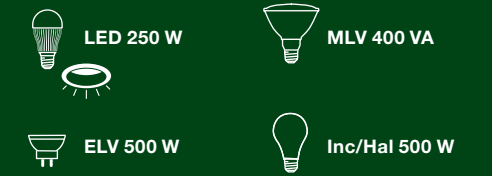

Available in 4 gloss colors

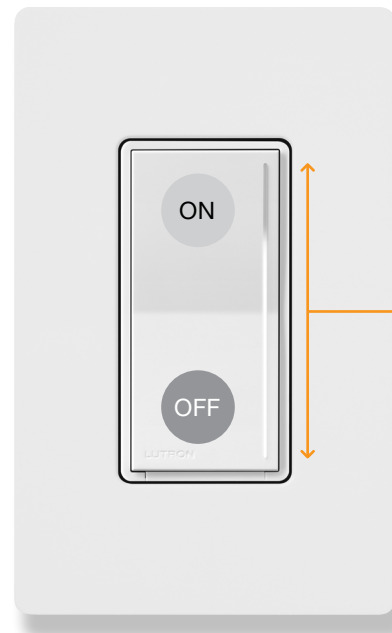

Adjust:
(Light Bar)
Touch or swipe to adjust lights
Slide to adjust light level

Tap ON once to turn on preset (default 100%)

Tap again to go to full brightness

Hold for 1 second to activate 30-second, delayed fade-to-off

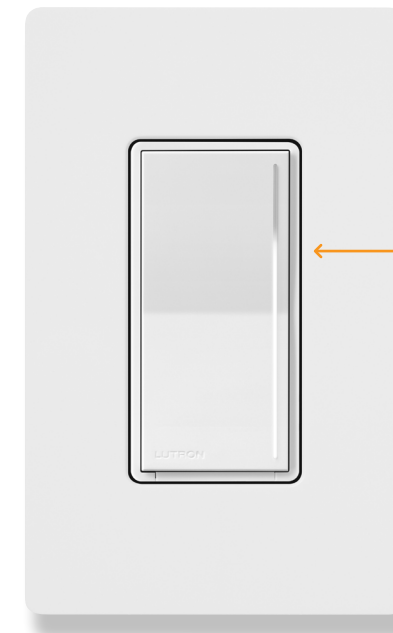
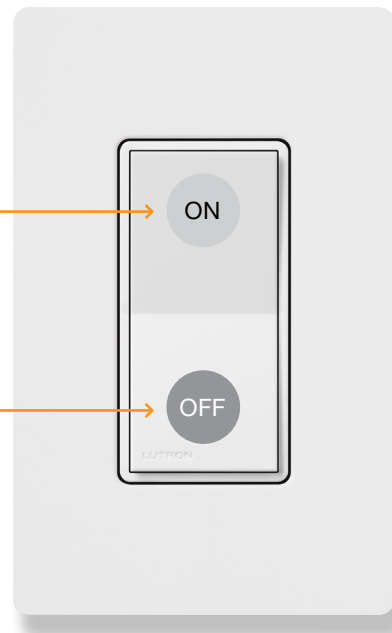

All the features of Sunnata LED+
Phase Selectable for ELV or MLV loads

Identical Companion dimmer with touch light bar
Tracking LEDs

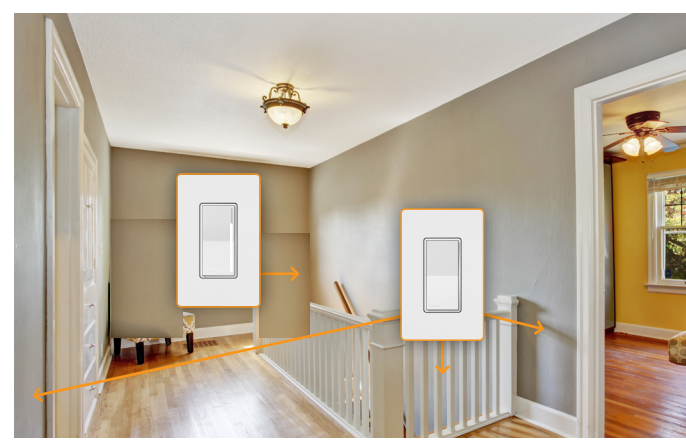
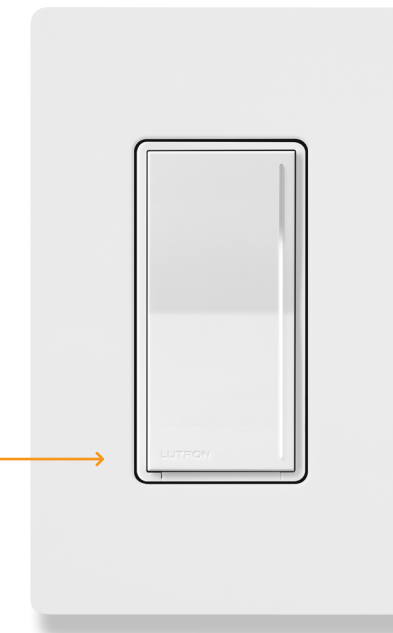

- For superior dimming of LED, Incandescent, and Halogen lighting
- Accessory switch provides matching look for 3-way and 4-way or works with existing mechanical switch in 3-way
- Dimming available from main location and lights fade on/off from others
- No neutral required



- Phase selectable for superior dimming of ELV, MLV, LED and incandescent/Halogen lighting
- RTISS technology reduces flickering lights by compensating in real time for incoming line voltage variations
- Identical Companion Dimmers to dim from every location
- Screw terminals allow for ease in wiring
- Neutral required

Accessory switch is only compatible with new Sunnata LED+ model STCL-153M



To customize the dimmer to your preferences, please visit lutron.com/MyLevel

Sunnata Switch

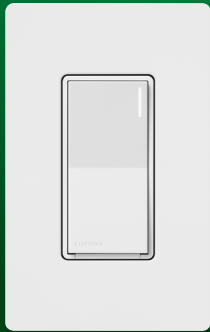

Sunnata Switch

ST-6ANS-XX

List Price:
\$135.00 USD
\$176.00 CAN

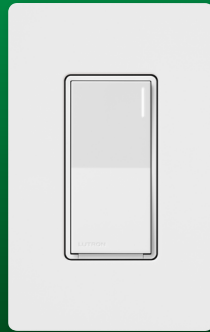

Sunnata Companion Switch

ST-RS-XX

List Price:
\$99.00 USD
\$125.00 CAN

Load ratings



6A lighting load



3A / 1/10 HP motor

Available in 4 gloss colors



WH (White)



LA (Light Almond)



IV (Ivory)



BL (Black)

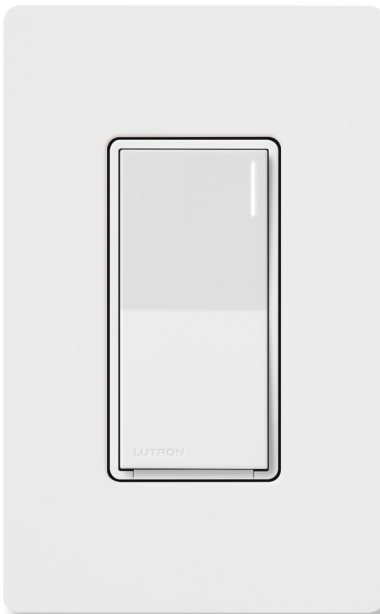

ST-6ANS-XX

- For non-dim applications including lighting and small motor loads
- Companion switch provides matching look for 3-way and 4-way
- Neutral required
- Locator light in every location

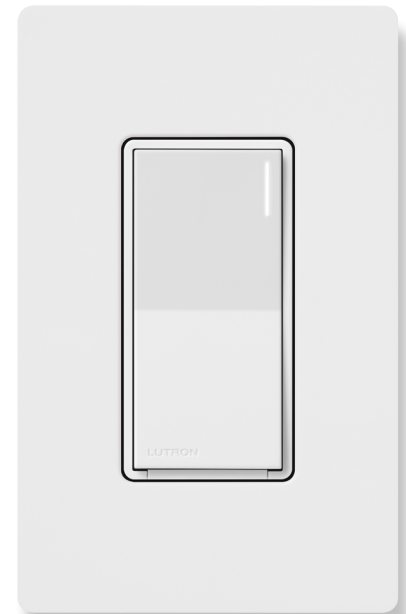

ST-RS-XX



Lutron.com

Lutron Electronics Co., Inc.,
7200 Suter Road, Coopersburg, PA 18036-1299

Customer Assistance

Online: lutron.com/help
Email: support@lutron.com
Phone: 1.844.LUTRON1 (588.7661)
includes 24/7 technical support

